

# Serrature a levetta serie 400-500

## Modello 561D

### Caratteristiche:

- serratura meccanicamente Ri-Programmabile
- realizzata in ottone
- finitura esterna nichel
- rotazione 90° antioraria
- resistente ad apertura con metodo "bumping"
- resistente ad apertura con grimaldelli - "picking"
- versione HS con spine antiforatura

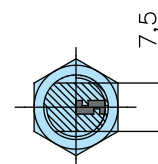
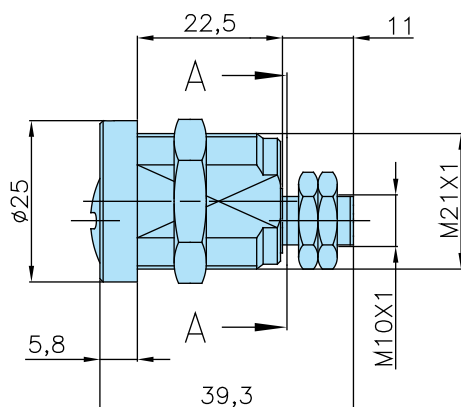
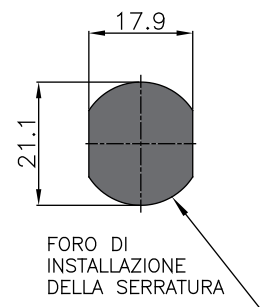
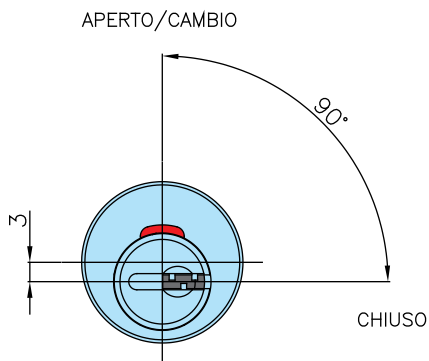

A - A